

S:\suskpr\01-21\001-21-WASTE-CAPITL-PLAN.dwg, SHEET 3, 7/17/2006 1:19:33 PM, gwilliams

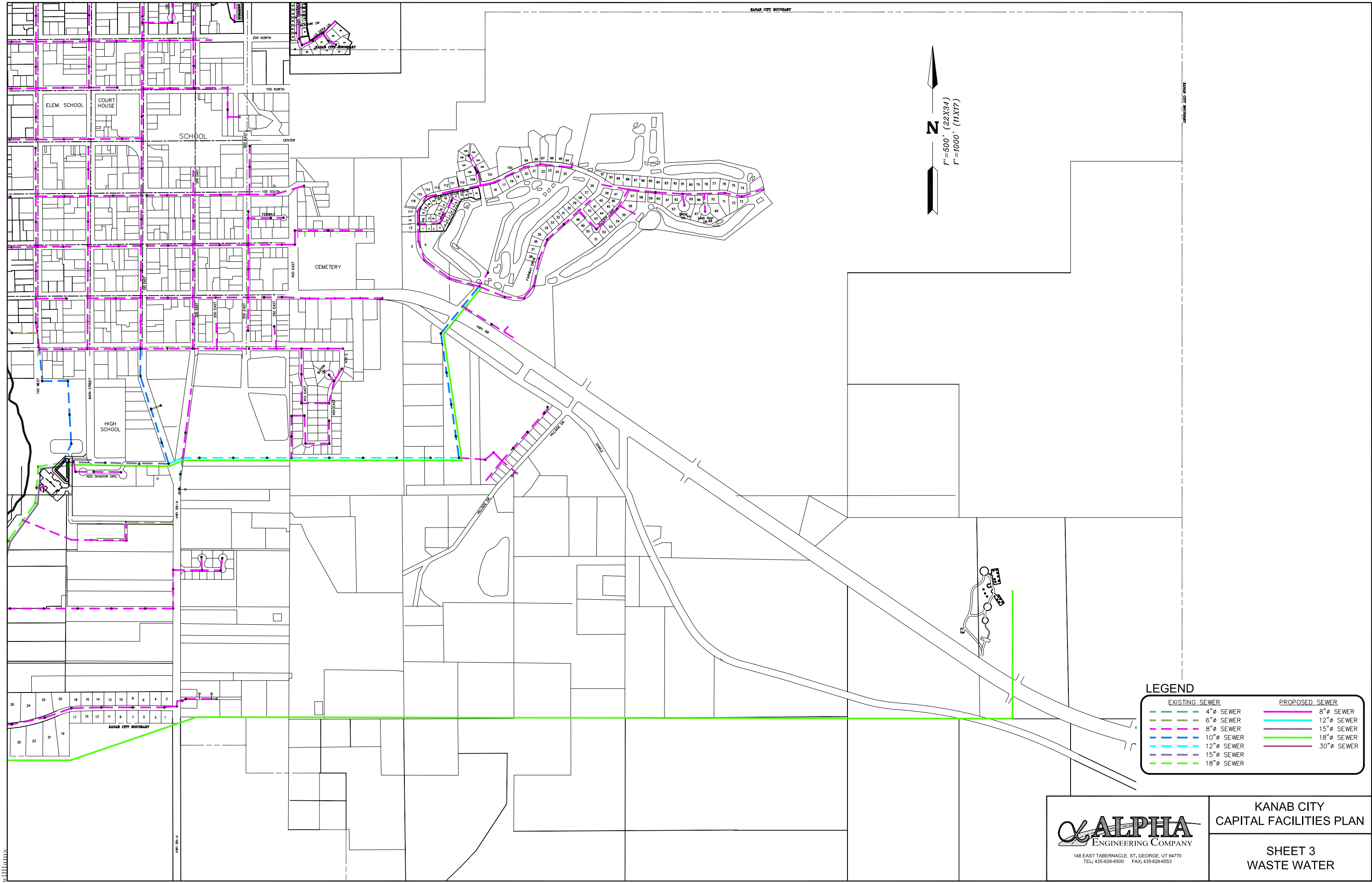

N  
1" = 500' (22X34)  
1" = 1000' (11X17)

EXISTING SEWER		PROPOSED SEWER	
	4" SEWER		8" SEWER
	6" SEWER		12" SEWER
	8" SEWER		15" SEWER
	10" SEWER		18" SEWER
	12" SEWER		30" SEWER
	15" SEWER		
	18" SEWER		

 148 EAST TABERNAACLE, ST. GEORGE, UT 84770 TEL: 435-628-6500 FAX: 435-628-6553	<b>KANAB CITY CAPITAL FACILITIES PLAN</b>
	<b>SHEET 3 WASTE WATER</b>